



METPAR CORP

95 State Street, Westbury, NY 11590
Tel: (516)-333-2600 fax: 516-333-2618
sales@metpar.com ~ www.metpar.com

TOILET PAPER DISPENSER CHROME SINGLE SURFACE MOUNTED

Model # TTD-100-S

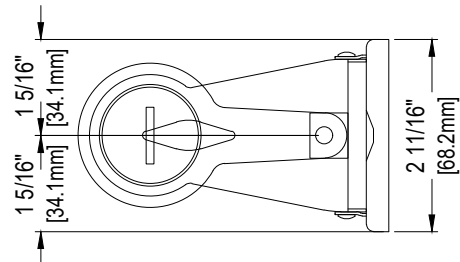
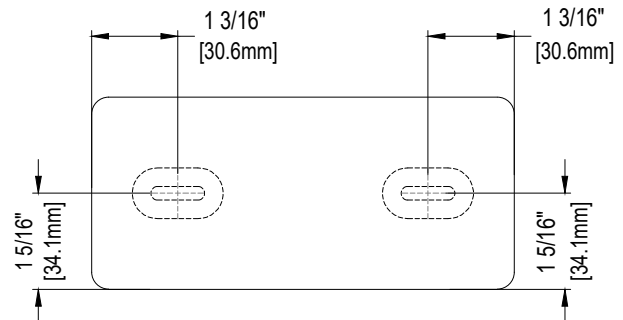
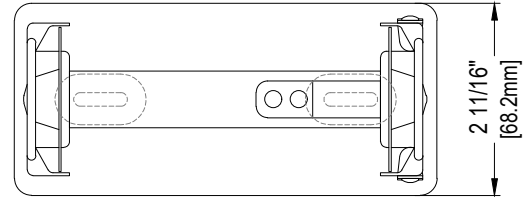
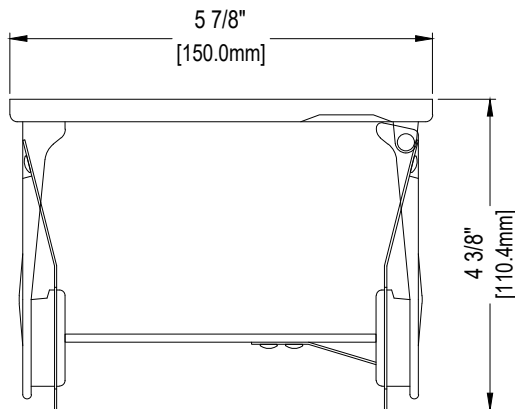

SPECIFICATION

Surface Mounted Chrome Single Toilet Tissue Dispenser shall be fabricated of #22-gauge polished chrome-plated steel for maximum strength, equipped with vandal-resistant self-locking mechanism and two heavy-duty brake springs providing controlled delivery for the roll of toilet paper, and accommodate one (1) standard-core toilet tissue roll up to 5" (127mm) OD (outside diameter) with a maximum width of 4-¹¹/₁₆" (119mm). Hinged arm and fixed arm are #22-gauge polished chrome-plated. Toilet tissue core to prevent access to release catch spring and roll shall be non-removable until roll is depleted.

Overall Dimensions: 5 ⁷/₈" W x 2 ¹¹/₁₆" H x 4 ³/₈" D (150mm x 68.2mm x 110.4mm).

Surface Mounted Chrome Single Toilet Tissue Dispenser shall be Model #TTD-100-S of Metpar Corporation, 95 State Street, Westbury, NY 11590.

OPERATION

Toilet paper is dispensed with controlled delivery from the roll. Roll will not spin freely. Roll is replaced on a cycle determined by maintenance needs. Roll core prevent access to release catch and must be removed to allow end support arms to swing away for service roll replacement.

INSTALLATION

Unit to be surface mounted at desired or specified location on wall or partition using two (2) No. 8 self-tapping screws furnished by manufacturer through mounting slots in back plate. For compliance with ADA Accessibility Guidelines, install unit so that centerline of holder is a minimum of 15" (381mm) above finished floor to a maximum of 48" (1219mm) above finished floor and centerline of dispenser shall be a minimum of 7" (178mm) to a maximum of 9" (229mm) from leading edge of the water closet and no more than 36" (914mm) from the back wall of stall.